





Gripper chains are used to convey plastic film in “form, fill and seal” packaging machines.

Series	Clamp Design	Clamp Features				Base Chain Material	Corrosion Resistance	Wear Resistance
		Film Retention	Spring Force	Clamp Material	Spring Material			
TFK	 K Style Clamp	Very high	50 N	SS	SS	S + NC	Good	Excellent
						SS	Excellent	Good
TF	 Standard Clamp	High	85 N	SS	SS	S + NC	Good	Excellent
						SS	Excellent	Good
		Average	50 N			S + NC	Good	Excellent
						SS	Excellent	Good
TF Long	 Long Clamp	High	80 N	SS	S + NC	S + NC	Good	Excellent
TFO	 Horizontal Clamp	Average	60 N	SS	SS	S + NC	Good	Excellent

## MATERIALS

Type	Description	Features
S + NC	<b>Carbon Steel Nickel Plated</b>	Through hardened carbon steel and electroless nickel plating for good corrosion resistance. Excellent strength and wear resistance.
SS	<b>Austenitic Stainless Steel</b>	Cr-Ni austenitic stainless steel. AISI 302-304 (Wn 1.4301). Excellent corrosion resistance.

## FILM RETENTION CHARACTERISTICS

Type	Features
Very High	Film retention force is not related only to spring load. <b>TFK clamp design</b> ensures very high film retention with low spring loads, with immediate benefits in chain & clamp wear life.
High	Film retention is increased through higher spring load.
Average	Standard clamping force, for medium/low weight application.



## PRODUCT FEATURES

- All chains are available in nickel plated and stainless steel construction, for outstanding corrosion resistance.
- Improved clamp design for increased film retention and smooth operation.
- Supplied in pre-stretched and matched strands for trouble free machine set-up.
- Special lubrication applied at factory, FDA H1 approved grease, for higher wear and corrosion resistance.

# K STYLE CLAMP

## 126TFK

### ISO 08B-1 : 1/2" K style clamp

The K style clamp allows a vertical movement combined with side rotation (kick-back) to ensure easy film engagement and scrap release.

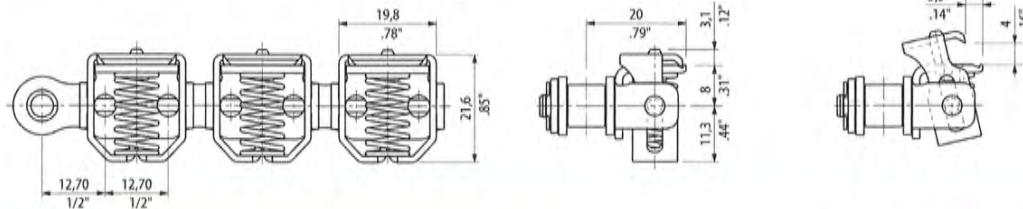

## 136TFK

### ISO 10B-1 : 5/8" K style clamp

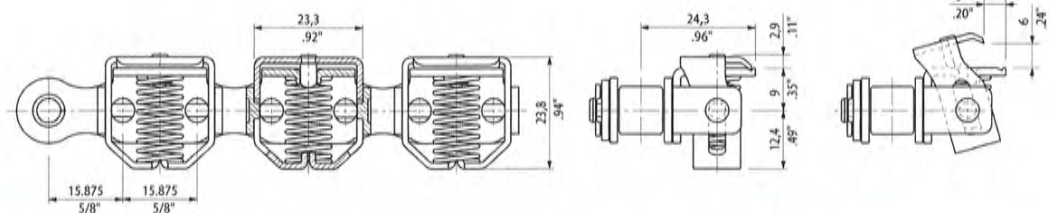

REGINA REF.	BASE CHAIN MATERIAL	CLAMP MATERIAL	SPRING MATERIAL	CHAIN PITCH P		ROLLER DIAMETER Dr		INSIDE WIDTH W		CLAMPING FORCE N
				mm	inches	mm	inches	mm	inches	
126TFK	S + NC	SS	SS	12,70	1/2	8,51	.335	7,75	.305	50
136TFK	S + NC	SS	SS	15,875	5/8	10,16	.400	9,65	.380	55
SS136TFK	SS	SS	SS	15,875	5/8	10,16	.400	9,65	.380	55

NEW

# SPROCKETS FOR K STYLE CLAMPS

### Fully Interchangeable

Large range of K style sprockets available from stock

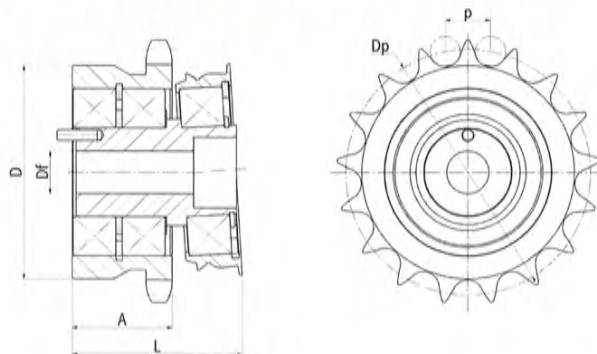

REGINA REF.	N° TEETH Z	CHAIN TYPE	L	A	Dp	D	Df
			mm	mm	mm	mm	mm
GS88	14	136 TFK	49,3	28,00	71,34	60,00	12,00
GS89	17	126 TFK	47,6	28,00	69,12	60,00	12,00
GS106	(14)*	136 TFK	63,5	41,90	71,34	60,00	12,00
GS107	21	136 TFK	77,7	55,90	106,51	65,50	12,00

\* Flat wheel without teeth

# STANDARD CLAMP DESIGN

Morskate®

## 126TFNC

### ISO 08 B-1 : 1/2" STANDARD clamp

Standard and hard spring versions. The standard clamp opens vertically with a slight side movement to follow the cam shape.

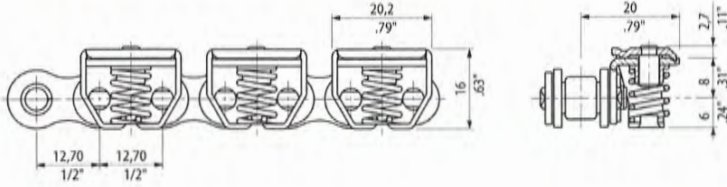

REGINA REF.	BASE CHAIN MATERIAL	CLAMP MATERIAL	SPRING MATERIAL	CHAIN PITCH P		ROLLER DIAMETER Dr		INSIDE WIDTH W		CLAMPING FORCE N
				mm	inches	mm	inches	mm	inches	
126TFNC	S + NC	SS	SS	12,70	1/2"	8,51	.335	7,75	.305	50
126TFNC/055	S + NC	SS	SS	12,70	1/2"	8,51	.335	7,75	.305	85
SS126TF	SS	SS	SS	12,70	1/2"	8,51	.335	7,75	.305	50
SS126TF/019	SS	SS	SS	12,70	1/2"	8,51	.335	7,75	.305	85

# LONG CLAMP DESIGN

## 126TFNC/04A

### ISO 08 B-1 : 1/2" LONG clamp

The long clamp allows wider opening and higher clamping force.

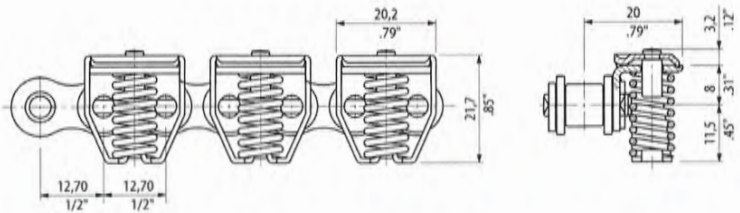

REGINA REF.	BASE CHAIN MATERIAL	CLAMP MATERIAL	SPRING MATERIAL	CHAIN PITCH P		ROLLER DIAMETER Dr		INSIDE WIDTH W		CLAMPING FORCE N
				mm	inches	mm	inches	mm	inches	
126TFNC/04A	S + NC	SS	S + NC	12,70	1/2"	8,51	.335	7,75	.305	80

# HORIZONTAL CLAMP DESIGN

## 126TFO

### ISO 08 B-1 : 1/2" HORIZONTAL clamp

Two springs of 30N each for uniform film clamping and control of film tension.

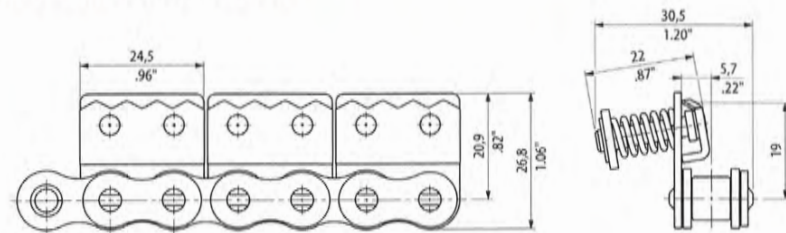

REGINA REF.	BASE CHAIN MATERIAL	CLAMP MATERIAL	SPRING MATERIAL	CHAIN PITCH P		ROLLER DIAMETER Dr		INSIDE WIDTH W		CLAMPING FORCE N
				mm	inches	mm	inches	mm	inches	
126TFO	S + NC	SS	SS	12,70	1/2"	8,51	.335	7,75	.305	60

NEW

# ONLY FROM REGINA AVAILABILITY IN FULL STAINLESS STEEL CONSTRUCTION

**AUSTENITIC STAINLESS STEEL  
OUTSTANDING CORROSION RESISTANCE**

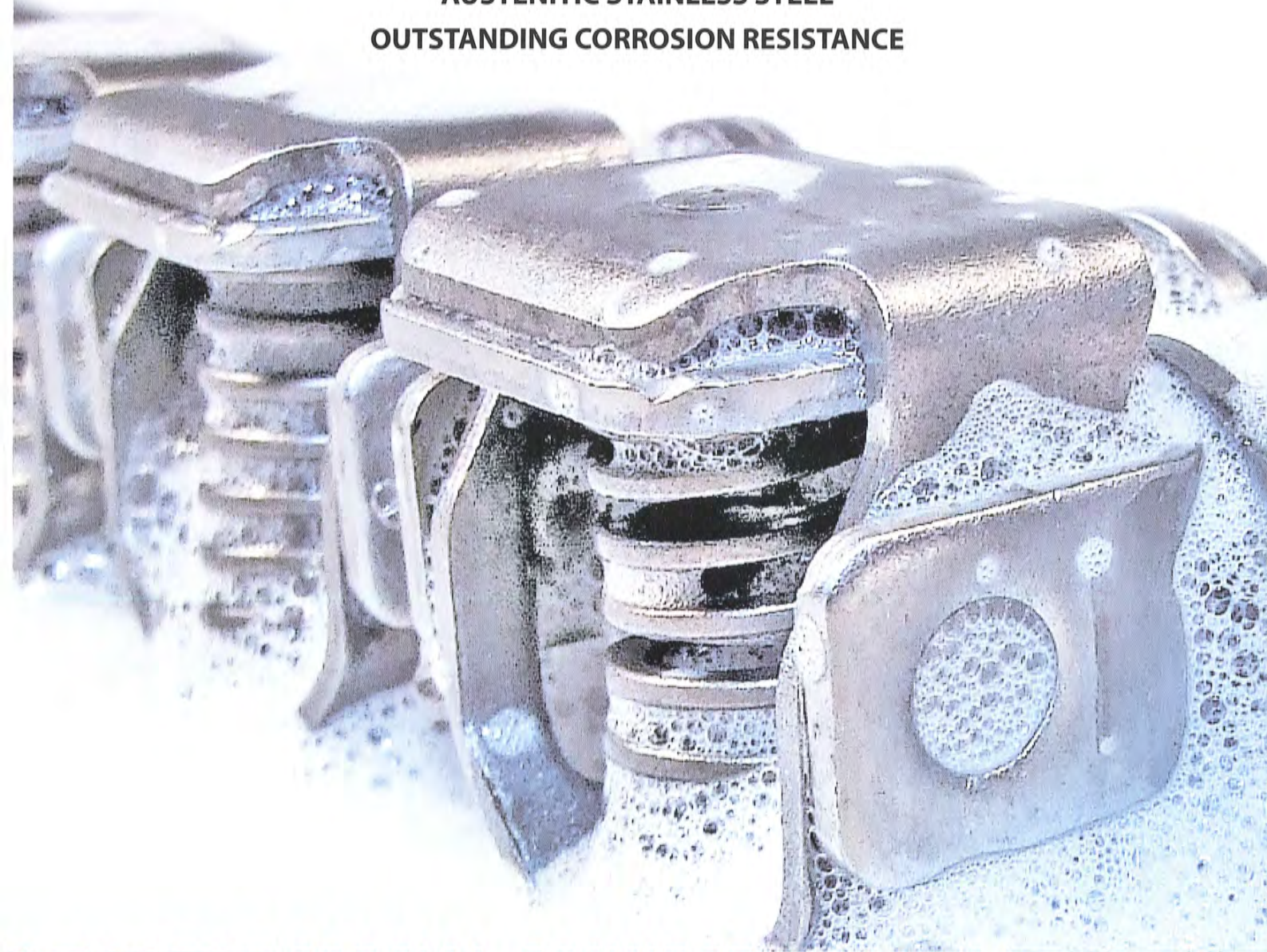

## SPECIAL CONNECTING LINK

**EASY ASSEMBLY SPRING CLIP  
EASY TO LOCATE WITH IDENTIFICATION HOLE**



Spring clip

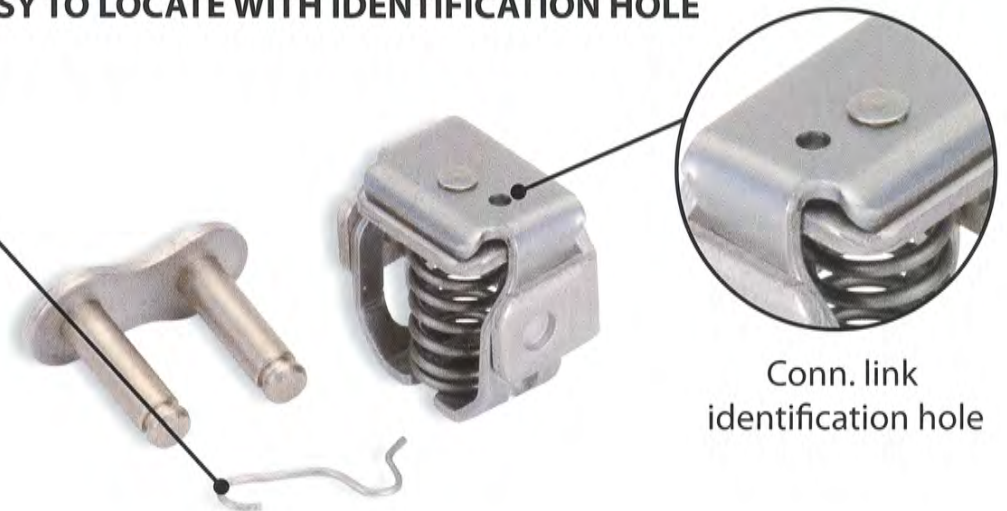

Conn. link  
identification hole